



Eagle Tugs Service Bulletin

ESB-01-10

Date: July 28, 2010

Affected Models: All eTT Tractors

Subject: TB172/2 Transfer Case Fill Procedure

Background:

Carraro has issued a specific gear oil fill requirement for the TB172/2 transfer case used in the eTT tow tractors. Following this fill procedure will provide the optimum performance in your tractor.

Oil Specification:

Oil Standard: API GL4

Weight: Appropriate for climate

Your tractor was filled at the factory with Castrol Trans-C 50W (P/N 3950)

eTT Transfer Case Fluid Level Check Procedure:

- 1) Remove the fill plug located behind the access panel in the eTT operator workstation
- 2) Use a tool such as a bent piece of wire to verify that the surface of the transfer case fluid is 1 1/4" (32mm) below the bottom edge of the fill plug hole.
- 3) If fluid is off by more than 1/4" (6mm), fill or drain fluid to correct.

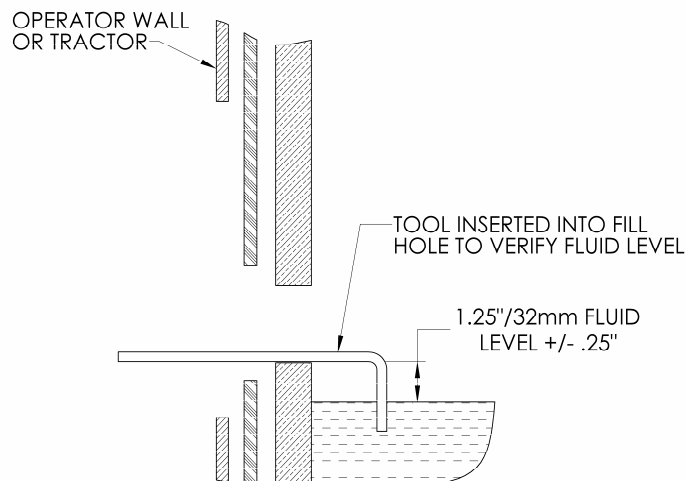



Eagle Tugs Service Bulletin

ESB-01-10

eTT Transfer Case Fill Procedure (if transfer case is empty):

- 1) Verify that the drain plug is secure in the bottom of the transfer case.
- 2) Remove the fill plug located behind the access panel in the eTT operator workstation
- 3) Put 4 1/4 quarts (4 liters) of API GL4 gear oil in the fill plug. Verify with the above check procedure.
- 4) Once the level is verified, replace the fill plug

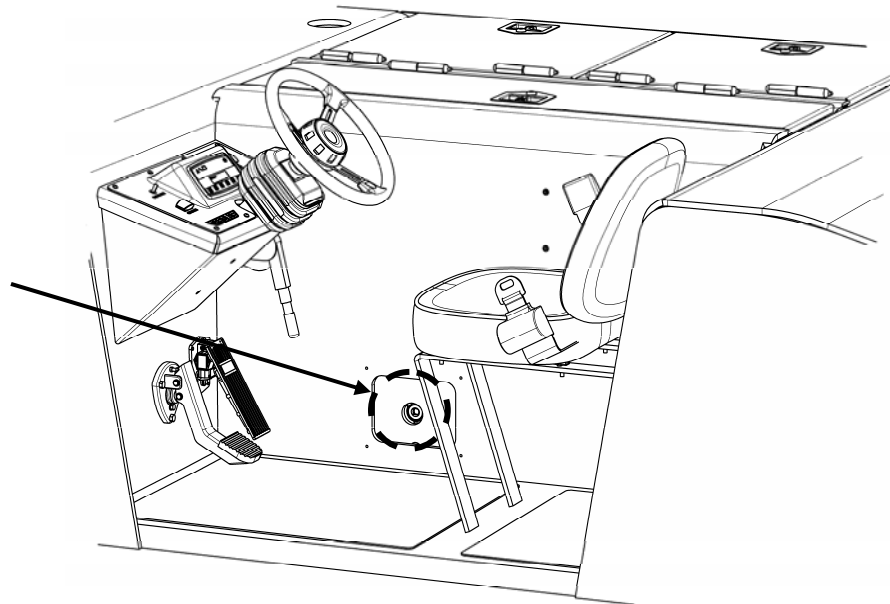



Eagle Tugs Service Bulletin

ESB-01-10

eTT Transfer Case Drain Procedure:

- 1) Lift the truck up to provide access to the bottom of the transfer case. Be sure to secure with jackstands or another appropriate means verifying that they are rated for the appropriate load capacity to handle the tractor. Refer to the data panel on the tractor for gross weight.
- 2) Remove the fill plug located behind the access panel in the eTT operator workstation.
- 3) Remove the drain plug located on the rear of the transfer case. This will drain the fluid.
- 4) Replace the drain plug and proceed to filling the transfer case.

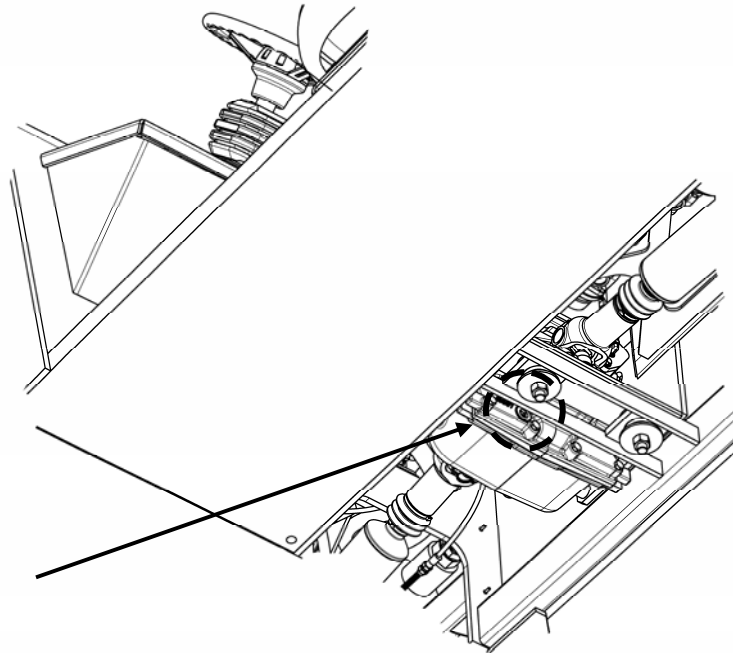

If you have any questions, please contact Eagle technical support at 734-442-1000.